

a maximum width of 1.5 – 2 times the height to the top of the window to ensure daylighting reaches well into the interior

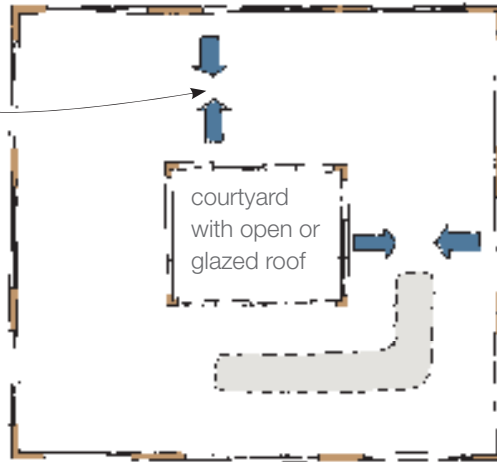

Maximising daylight and ventilation with a courtyard.

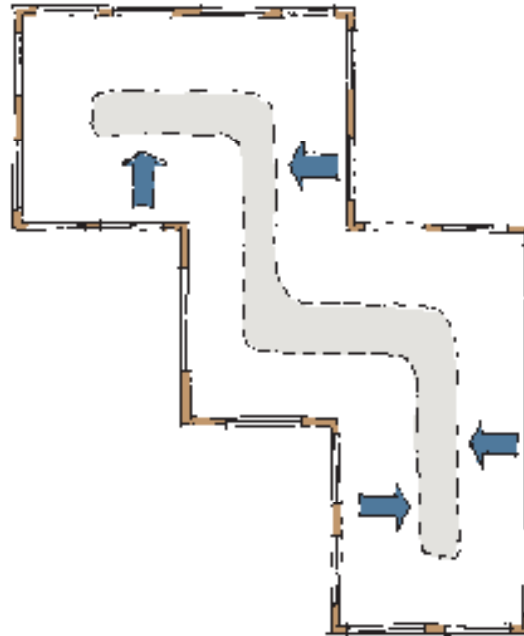

Maximising daylight and ventilation through irregular design.

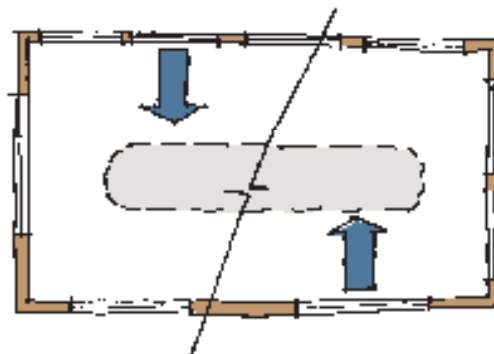

Maximising daylight and cross ventilation, with rectangular plan.

Maximising daylight and ventilation

To ensure daylight reaches the back wall of a space, make sure the distance from window to wall is no more than 1.5-2 times the height at the top of the window. Designing spaces that are not too wide also aids cross-ventilation.